

31' Tug Yacht — 31' x 29'-6" x 13' x 3'

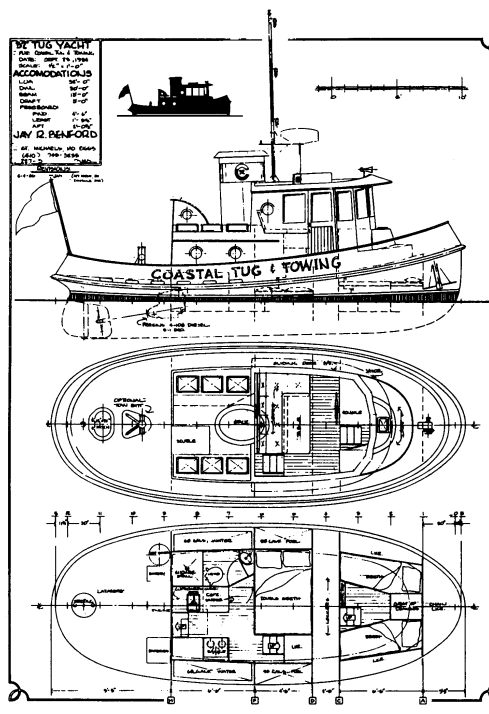

32' Tug Yacht 32' x 30' x 13' x 3'

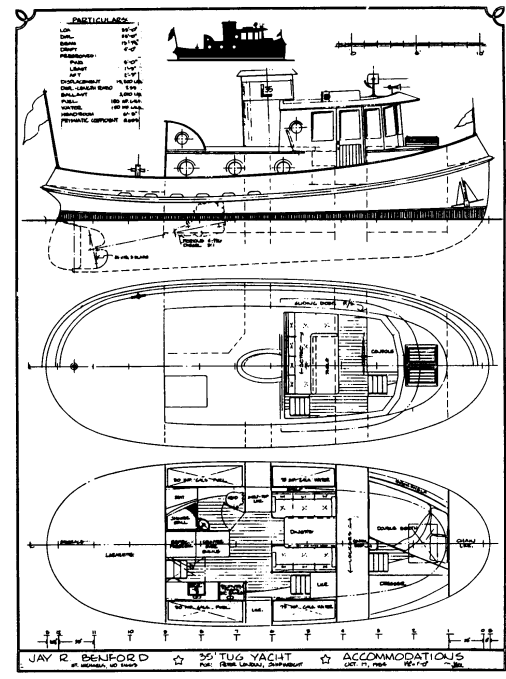

35' Tug Yacht 35' x 33' x 13'-7½" x 4'

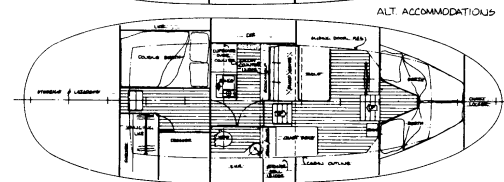
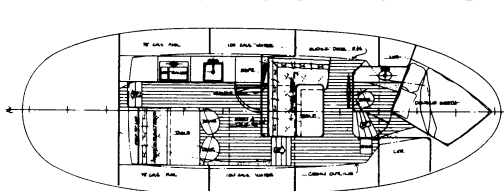
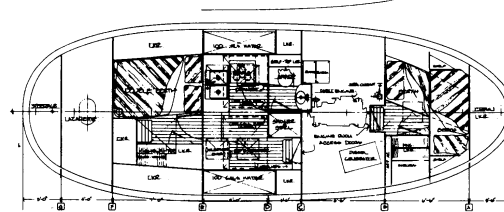
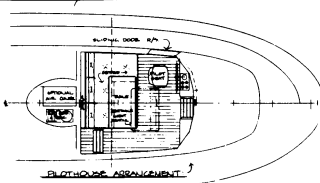
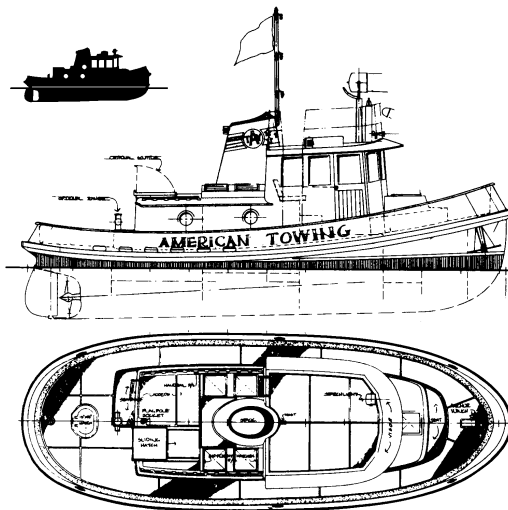

38' Tug Yacht — 38' x 36' x 14' x 4'

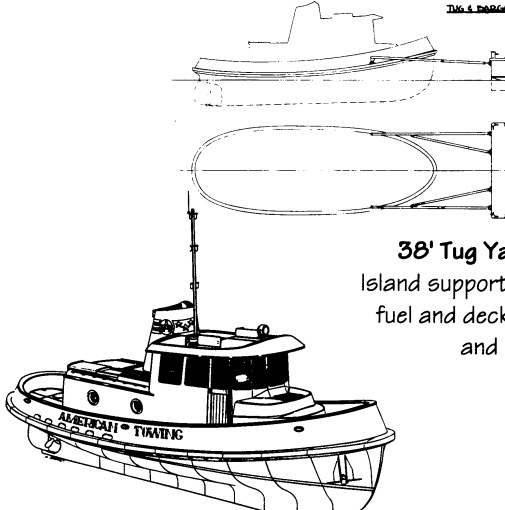

38' Tug Yacht & 40' Barge
Island support vessels for carrying
fuel and deck-loaded equipment
and machinery.

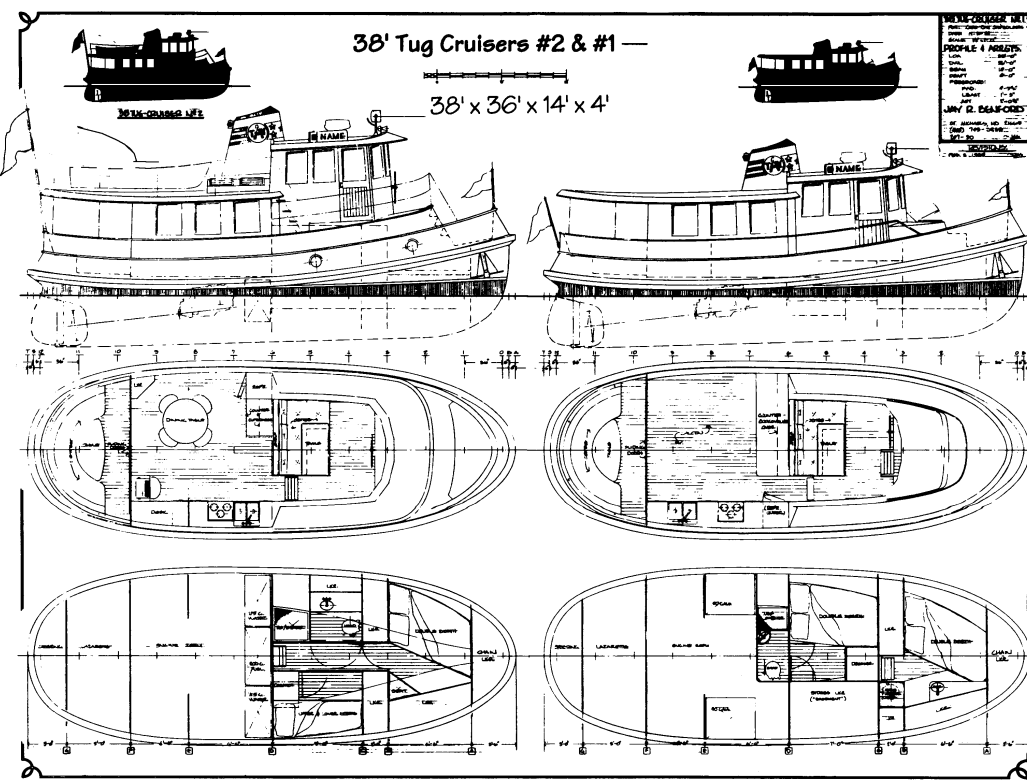
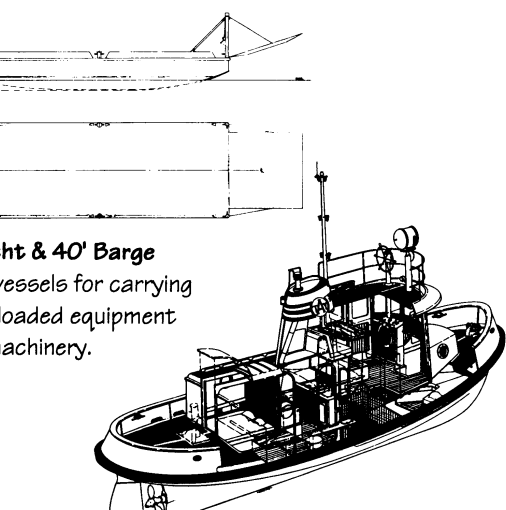

38' Tug Cruisers #2 & #1 —

38' x 36' x 14' x 4'

Tug Yachts

Since I started designing working tugs almost three decades ago, I've long admired their no-nonsense salty appearance. These Tug Yachts are drawn on that heritage, keeping the true tug "look" and adding useful and practical cruising accommodations.

Study plans for all these Tug Yacht designs are shown in greater detail in our book, **SMALL SHIPS**. It also has photos and more detailed information about them and scores of our other power boat designs. For more information about **SMALL SHIPS**, see our price list, **DESIGNS & SERVICES**.

These tug designs can be used for work or play, serving a variety of needs. Their styling makes them appealing to both those retiring from sailing and the power boater who wants a more economical way to cruise.

"...let me say that I have spent hours perusing **Small Ships**...to my utter delight. Here is Benford at his best.... It's a book which will be referred to again and again."

Ted Jones, **Coastal Cruising**

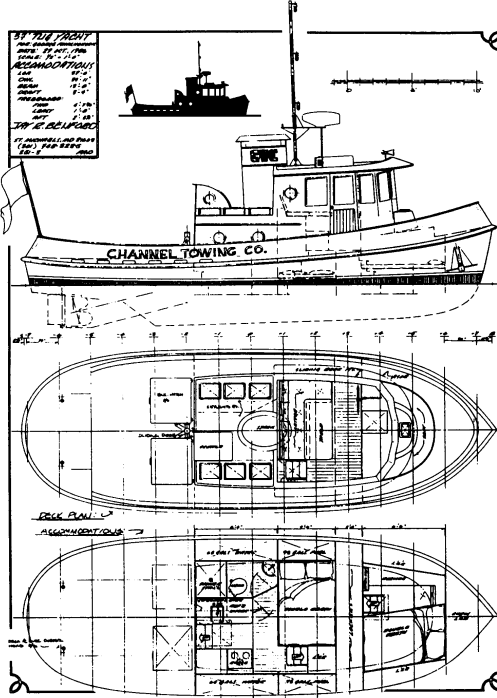

37' Tug Yacht 37' x 34'-11" x 12'-4" x 3'-4"

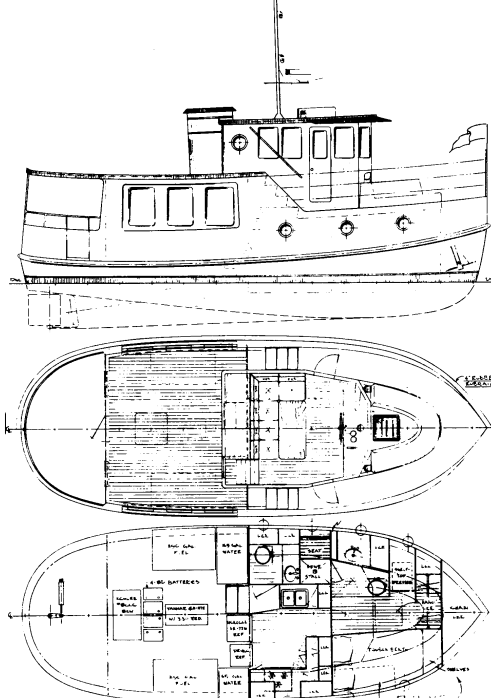

37' Tug Yacht — 37' x 35' x 14' x 3'-6"

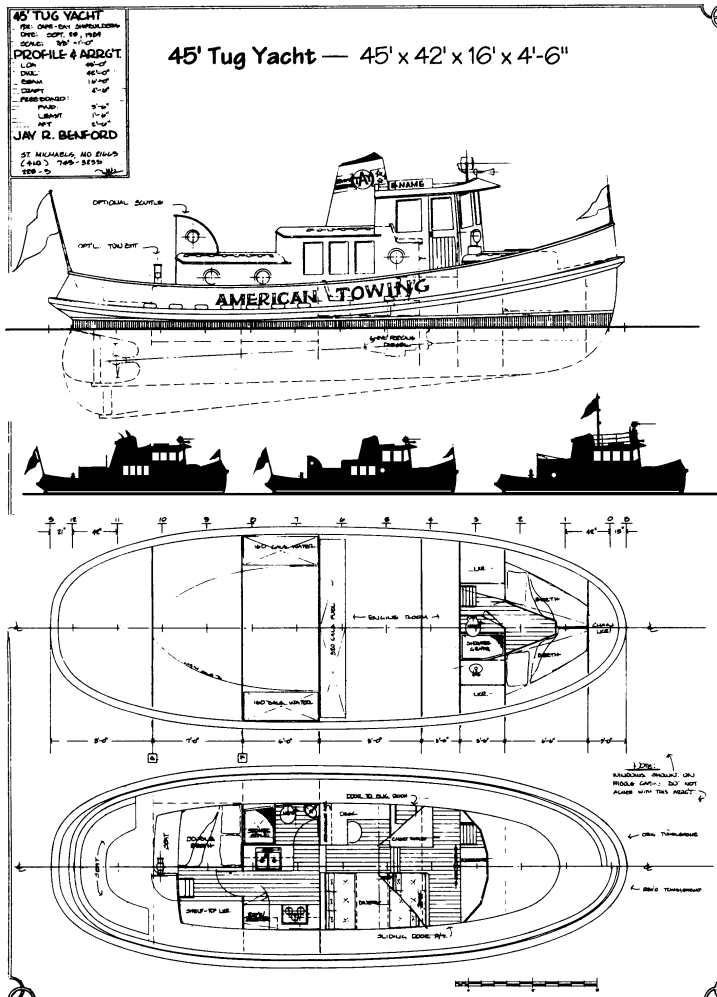
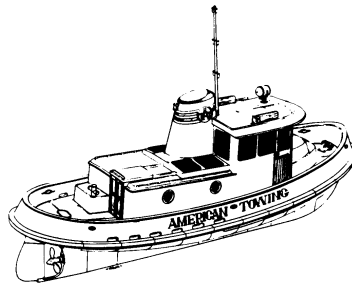

45' Tug Yacht — 45' x 42' x 16' x 4'-6"

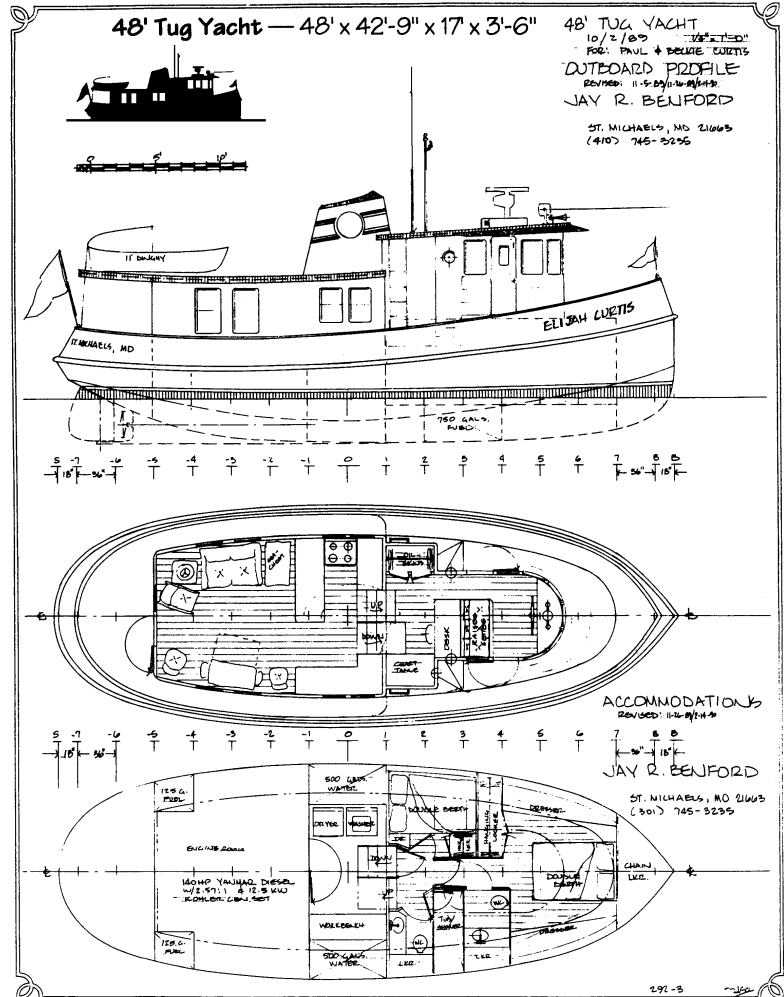

48' Tug Yacht — 48' x 42'-9" x 17' x 3'-6"

48' TUG YACHT
10/2/80
FOR: PAUL & BECKIE CURTIS
OUTBOARD PROFILE
REVISED: 11-5-89 (11-5-89)
JAY R. BENFORD
ST. MICHAELS, MD 20686
(410) 745-5235